

STROBE WARNING LIGHT HD-15

1. Installation Tips

- Make sure to install the unit as firm as possible.
- Only install the unit within the recommended temperature range (-20°C ~ 60°C)
- Do not disassemble
- Stop power supply when the lamp is broken

2. Installation

① Unscrew the bolt from the bottom



② Divide base and cover (Grab the lower part and slide it up)



③ Push the wire knock open with screw driver and insert the wire

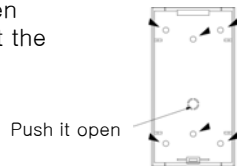

④ Secure base on the surface using bolts.

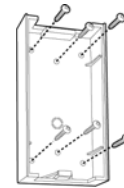

⑤ Connect wires.
Red - DC12V / Black - 0V

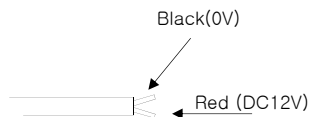

⑥ Put the cover back on and screw it.

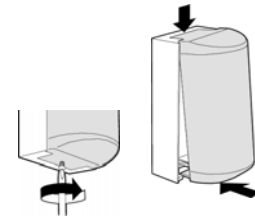

3. Specifications

Model Name	HD-15
Voltage	DC10V~16V(Polarity)
Current	120mA Max
Temperature	-20°C ~ 60°C
Humidity	40% ~ 80%RH
Lamp	Xenon Lamp
Blink Rate	60 Times per Minute (DC12V)
Installation Site	Wall
Structure	Anti-rain, Anti-dust Structure
Material	Cover - PC / Base - ABS Resin
Dimensions	74(W)x140(H)x78(D)mm
Weight	230g

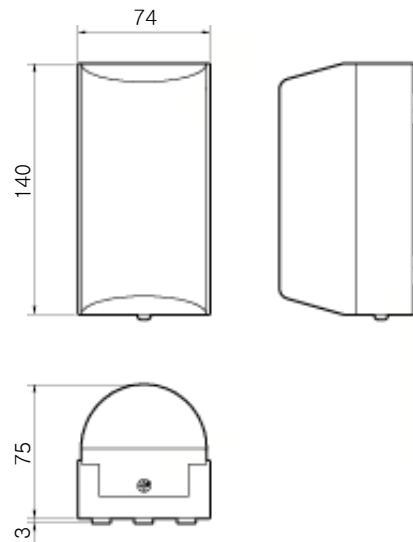

※ The above specifications can be changed without notice for developmental purposes.



1141 Budapest, Fogarasi út 77. 1095 Budapest, Mester u. 34.
Tel.: *220-7940, 220-7814, 220-7959, Tel.: *218-5542, 215-9771, 215-7550,
220-8881, 364-3428 Fax: 220-7940 216-7017, 216-7018 Fax: 218-5542
Mobil: 30 531-5454, 30 939-9989 Mobil: 30 940-1970, 30 959-0930

SASO.HU

E-mail: info@delton.hu Web: www.delton.hu